

GRS

LUG BOLTS

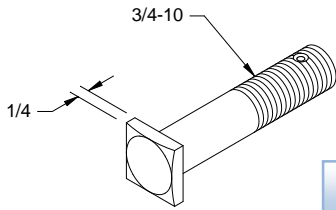

REF A

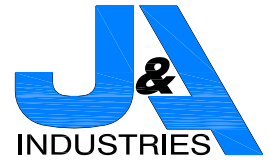
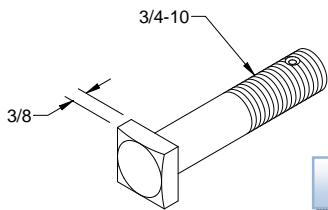

REF B

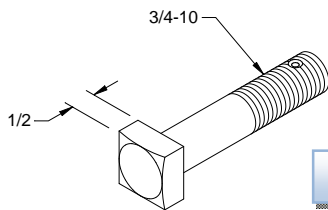

REF C

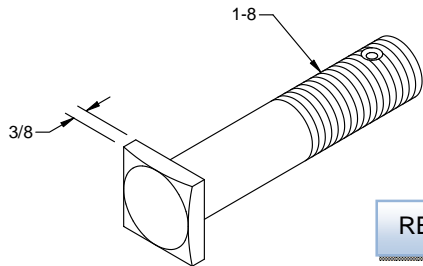

REF D

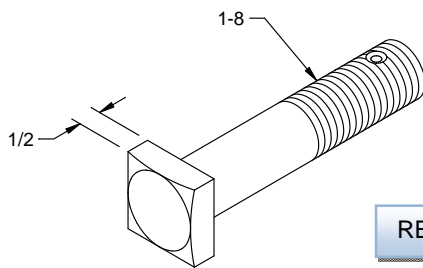

REF E

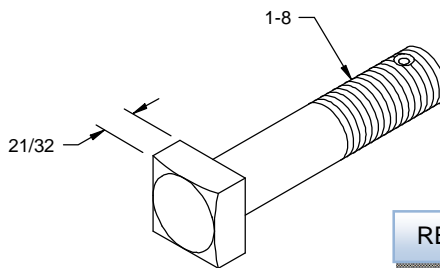

REF F

REF	O.E.M. #	J&A #		DESCRIPTION
		BOLT ONLY	W/ HDW	
A1	P91-160	140247-000	180114-000	3/4-10 X 3 1/2"
A2	P91-161	140247-001	180114-001	3/4-10 X 4"
A3	P91-162	140247-002	180114-002	3/4-10 X 4 1/2"
A4	P91-163	140247-003	180114-003	3/4-10 X 5"
A5	P91-164	140247-004	180114-004	3/4-10 X 5 1/2"

REF	O.E.M. #	J&A #		DESCRIPTION
		BOLT ONLY	W/ HDW	
B1	P91-170	140248-000	180111-000	3/4-10 X 3 1/2"
B2	P91-171	140248-001	180111-001	3/4-10 X 4"
B3	P91-172	140248-002	180111-002	3/4-10 X 4 1/2"
B4	P91-173	140248-003	180111-003	3/4-10 X 5"
B5	P91-174	140248-004	180111-004	3/4-10 X 5 1/2"

REF	O.E.M. #	J&A #		DESCRIPTION
		BOLT ONLY	W/ HDW	
C1	P91-180	140246-000	180112-000	3/4-10 X 3 1/2"
C2	P91-181	140246-001	180112-001	3/4-10 X 4"
C3	P91-182	140246-002	180112-002	3/4-10 X 4 1/2"
C4	P91-183	140246-003	180112-003	3/4-10 X 5"
C5	P91-184	140246-004	180112-004	3/4-10 X 5 1/2"

REF	O.E.M. #	J&A #		DESCRIPTION
		BOLT ONLY	W/ HDW	
D1	P91-190	140250-000	180087-000	1-8 X 3 1/2"
D2	P91-191	140250-001	180087-001	1-8 X 4"
D3	P91-192	140250-002	180087-002	1-8 X 4 1/2"
D4	P91-193	140250-003	180087-003	1-8 X 5"
D5	P91-194	140250-004	180087-004	1-8 X 5 1/2"
D6		140250-005	180087-005	1-8 X 6"
D7		140250-006	180087-006	1-8 X 6 1/2"

REF	O.E.M. #	J&A #		DESCRIPTION
		BOLT ONLY	W/ HDW	
E1	P91-200	140251-000	180113-000	1-8 X 3 1/2"
E2	P91-201	140251-001	180113-001	1-8 X 4"
E3	P91-202	140251-002	180113-002	1-8 X 4 1/2"
E4	P91-203	140251-003	180113-003	1-8 X 5"
E5	P91-204	140251-004	180113-004	1-8 X 5 1/2"
E6		140251-005	180113-005	1-8 X 6"
E7		140251-006	180113-006	1-8 X 6 1/2"

REF	O.E.M. #	J&A #		DESCRIPTION
		BOLT ONLY	W/ HDW	
F1	P91-210	140252-000	180106-000	1-8 X 3 1/2"
F2	P91-211	140252-001	180106-001	1-8 X 4"
F3	P91-212	140252-002	180106-002	1-8 X 4 1/2"
F4	P91-213	140252-003	180106-003	1-8 X 5"
F5	P91-214	140252-004	180106-004	1-8 X 5 1/2"
F6		140252-005	180106-004	1-8 X 6"
F7		140252-006	180106-004	1-8 X 6 1/2"

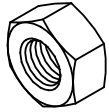

REF A

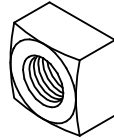

REF B

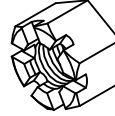

REF C

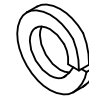

REF D



REF E

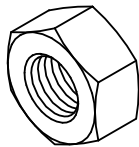

REF F

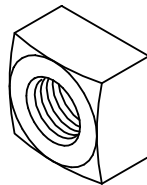

REF G

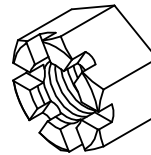

REF H



REF J

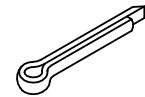

REF K

REF	O.E.M. #	J&A #	DESCRIPTION
A	P76-105	013115-010	NUT, HEAVY HEX, 3/4-10 Z/P
B	P91-221	013121-010	NUT, HEAVY SQUARE, 3/4-10 Z/P
C	P91-222	013114-010	NUT, SLOTTED, 3/4-10 Z/P
D	P85-105	013000-010	WASHER, SPLIT LOCK, 3/4"
E	P91-224	014001-0924	PIN, COTTER, 3/16" X 1 1/2" FOR REF 1-3
F	P03-105	013115-012	NUT, HEAVY HEX, 1-8 Z/P
G	P91-227	013121-012	NUT, HEAVY SQUARE, 1-8 Z/P
H	P91-228	013114-012	NUT, SLOTTED HEAVY HEX, 1-8 Z/P
J	P91-338	013000-013	WASHER, SPLIT LOCK, 1"
K	P91-231	014001-1124	PIN, COTTER, 1/4" X 1 1/2" FOR REF 6-8

- **We stock all types and sizes of hardware**
- **Contact J&A Industries if your part is not listed**

Standard lug bolt kit (-00X) has hex nut
 Slotted lug bolt kit (-10X) has slotted nut
 (See previous page)

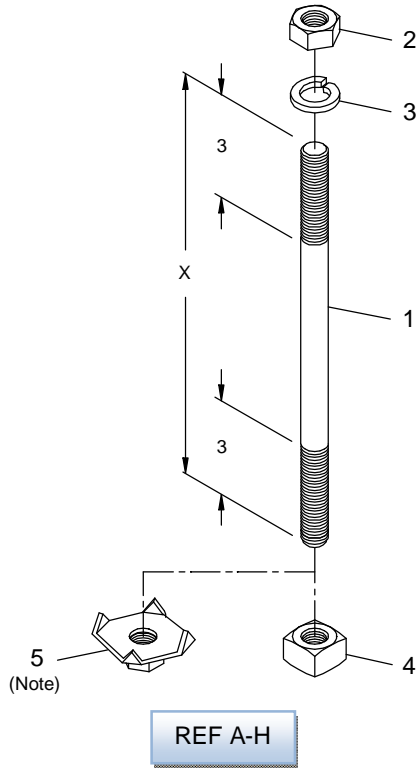

REF	J&A #	DESCRIPTION	X
A	180088-000	KIT, TIE BOLT, 3/4-10	11
B	180088-001	KIT, TIE BOLT, 3/4-10	16
C	180088-002	KIT, TIE BOLT, 3/4-10	17
D	180088-003	KIT, TIE BOLT, 3/4-10	13
E	180088-004	KIT, TIE BOLT, 3/4-10	12
F	180088-005	KIT, TIE BOLT, 3/4-10	10
G	180088-006	KIT, TIE BOLT, 3/4-10	8
H	180088-007	KIT, TIE BOLT, 3/4-10	14
1A	140304-000	STUD, 3/4-10	11
1B	140304-001	STUD, 3/4-10	16
1C	140304-002	STUD, 3/4-10	17
1D	140304-003	STUD, 3/4-10	13
1E	140304-004	STUD, 3/4-10	12
1F	140304-005	STUD, 3/4-10	10
1G	140304-006	STUD, 3/4-10	8
1H	140304-007	STUD, 3/4-10	14
2	013115-010	NUT, HEAVY HEX, 3/4-10 Z/P	
3	013000-010	WASHER, SPLIT LOCK, 3/4" Z/P	
4	013121-010	NUT, HEAVY SQUARE, 3/4-10 Z/P	
5	160216-000	NUT, GRIP, 3/4-10 Z/P (SPECIAL)	

Note: To select the grip type bolt kit add a (1) at the first of the part number suffix (-1XX). This will substitute ITEM 5 for ITEM 4

REF	J&A #	DESCRIPTION
J	225341-001	CABLE ENTR, 1 1/4" NPT F/ GRS SW MACH
K	225341-002	CABLE ENTR, 1 1/2" NPT F/ GRS SW MACH
L	225341-003	CABLE ENTR, 2" NPT F/ GRS SW MACH
M	225341-004	CABLE ENTR, 2" OD F/ GRS SW MACH
6J	110068-001	CABLE ENTR CPLG, 1 1/4" NPT
6K	110068-002	CABLE ENTR CPLG, 1 1/2" NPT
6L	110068-003	CABLE ENTR CPLG, 2" NPT
6M	110068-004	CABLE ENTR CPLG, 2" OD
7	018028-000	GASKET, 1/16" NEOPRENE
8	013203-024	SCREW, HEX HEAD CAP, 1/4-20 X 1 1/2"
9	013000-004	WASHER, SPLIT LOCK, 1/4"

